

# QUICK MANUAL – XFLAT EXTRACT

Xflat extraction unit – Extract – AC; EC

The Quick Manual guides you through the quick installation of the product, but in no way replaces the complete full manual. The complete operating instructions are available in the documents on our website [www.xvent.cz](http://www.xvent.cz) or you can access them via QR code.



**Check that there are no electrical or other wiring (e.g.: gas, water, etc.) running on the wall or ceiling in the interior that could be disturbed during installation. Make sure that the AC power supply to which you want to connect the unit meets the power requirements of the unit (rating plate).**



**Make sure that the installation of the unit does not endanger the statics of the building and meets all legislative safety requirements.**

## 1) Using the unit

- The Xflat Extract unit is an air handling unit designed for the central extraction of clean air free of dust and grease.

- The unit is offered in two versions:

- XF1-Xtract AC – AC fan unit, 3-speed setting, without controller (factory setting is 2nd speed),. For smooth remote change of speeds, accessories must be ordered (wireless controller – "XF-AC-RF, XF-AC-CP wired packet controller)
- XF1-Xtract EC – EC fan unit, infinitely variable speed adjustment using a potentiometer directly on the body of the unit, without an external controller. To control the unit remotely, order the "XF-EC-CP" accessory

- The unit is designed to be connected to the pipe both on the intake (1x Ø130/ Ø160 + 6x Ø75) and on the exhaust (1x Ø130/ Ø160). The unit must not be operated without piping.

The unit is intended for vertical and horizontal wall and ceiling installation only. The unit has constant pressure technology – the pressure in the air system does not decrease with increasing airflow requirements. The unit is designed for continuous operation in indoor and dry areas with a room temperature of +5 °C to +30 °C and a maximum relative humidity of 70% non-condensing. The maximum working altitude of the unit is 2000 m above sea level.



**The fresh air temperature supplied from the outside can range from -20 °C to +40 °C.**

## 2) Technical parameters

Type		XF1-EXTRACT- EC				
Speed		1/4 of the range minimum	2/4 of the range	3/4 of the range	4/4 of the range nominal airflow	BOOST maximum
Airflow*	m <sup>3</sup> /h / Pa	59 / 20	156 / 50	227 / 100	251 / 200	365 / 200
Acoustic level**	dB(A)	< 20dB	19,2	28,1	31,1	37
Weight***	kg	7				
Power supply	V/Hz	1 ~ 230 / 50				
Nominal input	W	2	12	32	55	121
Nominal current	A	0,07	0,12	0,25	0,43	0,93
Electric safety	IP	20				

Type		XF1-EXTRACT- AC		
Speed		Low	Middle	High
Nominal airflow*	m <sup>3</sup> /h / Pa	108 / 100	141 / 150	245 / 200
Acoustic level**	dB(A)	21,1dB	26,5	32,2
Weight***	kg	7		
Power supply	V/Hz	1 ~ 230 / 50		
Nominal input	W	55	61	85
Nominal current	A	0,25	0,27	0,36
Electric safety	IP	30		

\* Nominal airflow (power input, current, sound pressure) / external pressure drop

\*\* Sound pressure level in free space at a distance of 3m (Q2)

\*\*\* Unit weight without packaging

### Prohibited use of Xflat-200



- The unit must not be used to extract burning, glowing substances, flammable or explosive gases, aggressive media, liquids.
- The unit must not be installed just below the electronic. Socket, flammable materials, in environments with an increased risk of explosion, flammable substances, with increased dustiness and in environments with higher humidity, e.g.: bathrooms, swimming pools, saunas.

- Neither the manufacturer nor the supplier is liable for damage caused by improper use of the units. The risk is borne by the user

## 3) Installing the Xflat-200

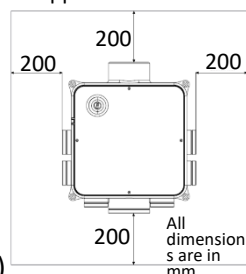
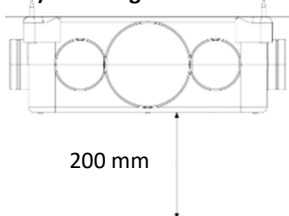

### - Minimum installation distances

The unit must be installed in such a way that the direction of airflow through the unit itself is identical to the airflow in the air handling system. Failure to observe the specified distances may cause the unit to not operate properly and may damage the fan, increase the noise level, or prevent block access to the unit.

**- Failure to follow the installation procedure may result in damage to the unit, malfunction, possible injury to the user's health and property.**



To read the QR code, use a smart device (mobile phone, tablet, etc.) that is equipped with this technology.



**- Not allowed Unit Positions**

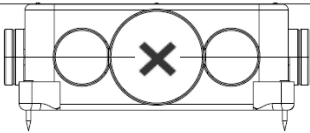

**- Allowed Unit Positions**

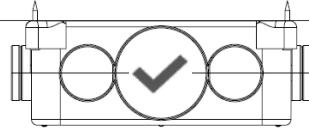

- Positioning in any other position is prohibited  
- Access to the unit must always be maintained from the front (lid side) for its adjustment and possible service. If the unit is placed under a wall or the ceiling (concealed), the wall or the ceiling must be equipped with an inspection opening for access to the unit.

**- Xflat Unit Installation Procedure - Extract**

a) Remove the unit from the package

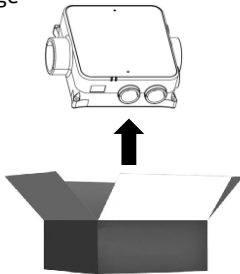

b) Measure the anchor holes – use the template from the bottom of the box or measure

Mounting holes – 437 mm

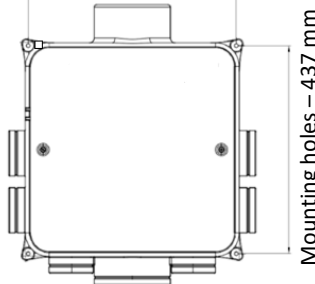

c) drill anchor holes, fit with suitable anchoring material using washers (included) on the individual feet and screw the unit

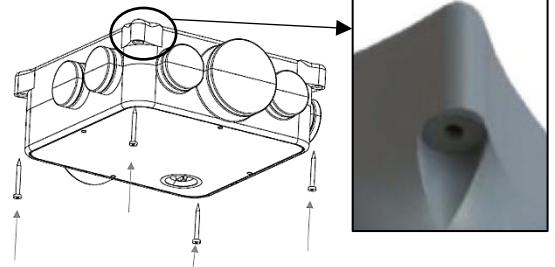

**- Connection of air ducts**

a) Pipe connection diagram to the unit

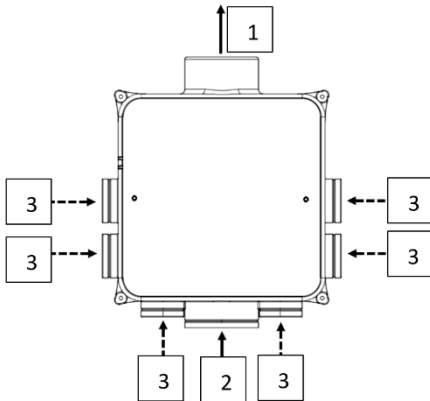

b) To connect the air ducts, use the prepared sockets in the unit  
-Be sure to observe the direction of the airflow and the connection dimensions of the duct:

- o Spigot 1 = Exhaust Ø130 / Ø160 mm (internal / external)
- o Spigot 2. = Extract Ø130 and Ø160 mm (internal / external)
- o Spigot 3 = Extract Ø75 (internal) – ready for flexi hose connection (not included)

c) To adjust the airflow in individual branches, use the included reducers. To select the correct flow, break in the inner rings of the reducer

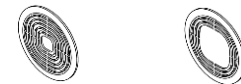

d) The reducer is inserted directly into the Extract spigots (3).

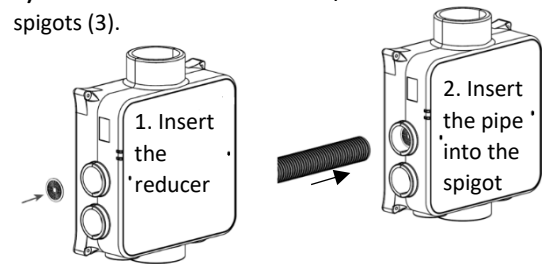

**4) Electrical installation – connection to the electrical network**



- Before starting any installation work, make sure that your main electrical installation box is equipped with a protective (green-yellow) wire.
- Verify that the power supply meets the power requirements of the unit (voltage, current, frequency, etc.) listed on the nameplate of the unit. Chapter 3.4.3. Display of electrical parameters.
- The relevant circuit must be protected in the power distribution system by a maximum of 6 A. The electrical cable for connection to the mains must not be broken. Local electrical codes must always be respected. The electrical connection of the unit to the mains may only be carried out by persons qualified for this activity with a valid authorization and knowledge of the relevant standards and directives in the given country.
- This device is an electrical device (according to Directive 2014/35/EU - LVD) and is intended to be fixed to an electrical installation. The device does not have an integrated power switch. Therefore, it is necessary that it is connected to an external switch and disconnecting element that meets the following requirements:
  - It must serve as the main switch of the device.
  - It must break all active wires.
  - It must be permanently accessible to the operator and clearly marked as the main switch for this unit.
- It must be capable of being locked against unintentional switching (e.g. lockable "off" position during maintenance).
- The supply must be switched off before starting any assembly work. It is forbidden to interfere in any way with the internal wiring of the unit, unauthorized interference with the unit may lead to the loss of warranty. This unit belongs to the product group with a type Y connection. If the power supply is damaged, it must be replaced by the manufacturer, its service center or a similarly qualified person in order to avoid a hazardous situation. The unit is classified as a protection class 1 appliance in terms of protection against electric shock.
- The supply voltage for the XF1-EXTRACT-AC 1~230V/50Hz unit and for the XF1-EXTRACT-EC 1~230V/50-60Hz unit must not be modified in any way, otherwise there is a risk of damage to the electrical elements of the unit.

**- Connecting the unit to the mains**

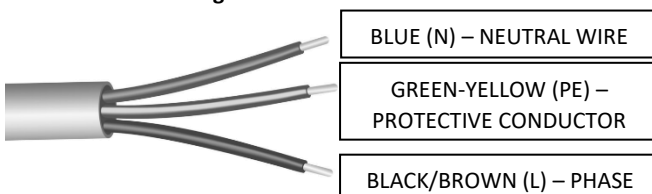

**- Connecting the unit to the wiring box**

- The power cable is prepared by the manufacturer for connection to the wiring box.
- To connect the power cable to the mains, use appropriate connecting elements (e.g.: terminal block, spring terminals, etc...)



The installation of the power cable in the wiring box and the subsequent connection to the mains must be carried out by a qualified person who is authorised for this activity and has knowledge of the relevant standards and directives in the given country.

**5) Regulation – air output adjustment**



- Nothing else needs to be connected to the unit to work properly. It is therefore ready for immediate use after installation.

**Always switch off the unit from the main power supply before accessing the control at any time.**

**- Control – Unit Setting – XF1-EXTRACT-AC**

- The unit is set to medium speed from the factory. Other air outputs should be set according to point 2) Technical parameters



**a) remove the two Ø3.5x20 flat head screws from the unit cover**

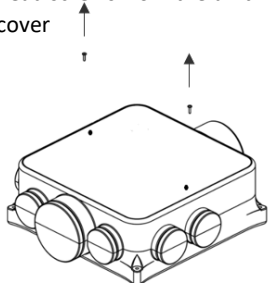

**b) Remove the lid from the unit**

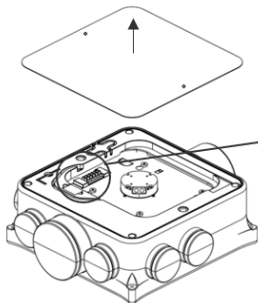

**c) reconnect the cable in the terminal block according to the diagram**

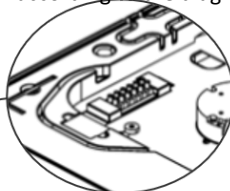

- Unit wiring diagram – XF-EXTRACT-AC

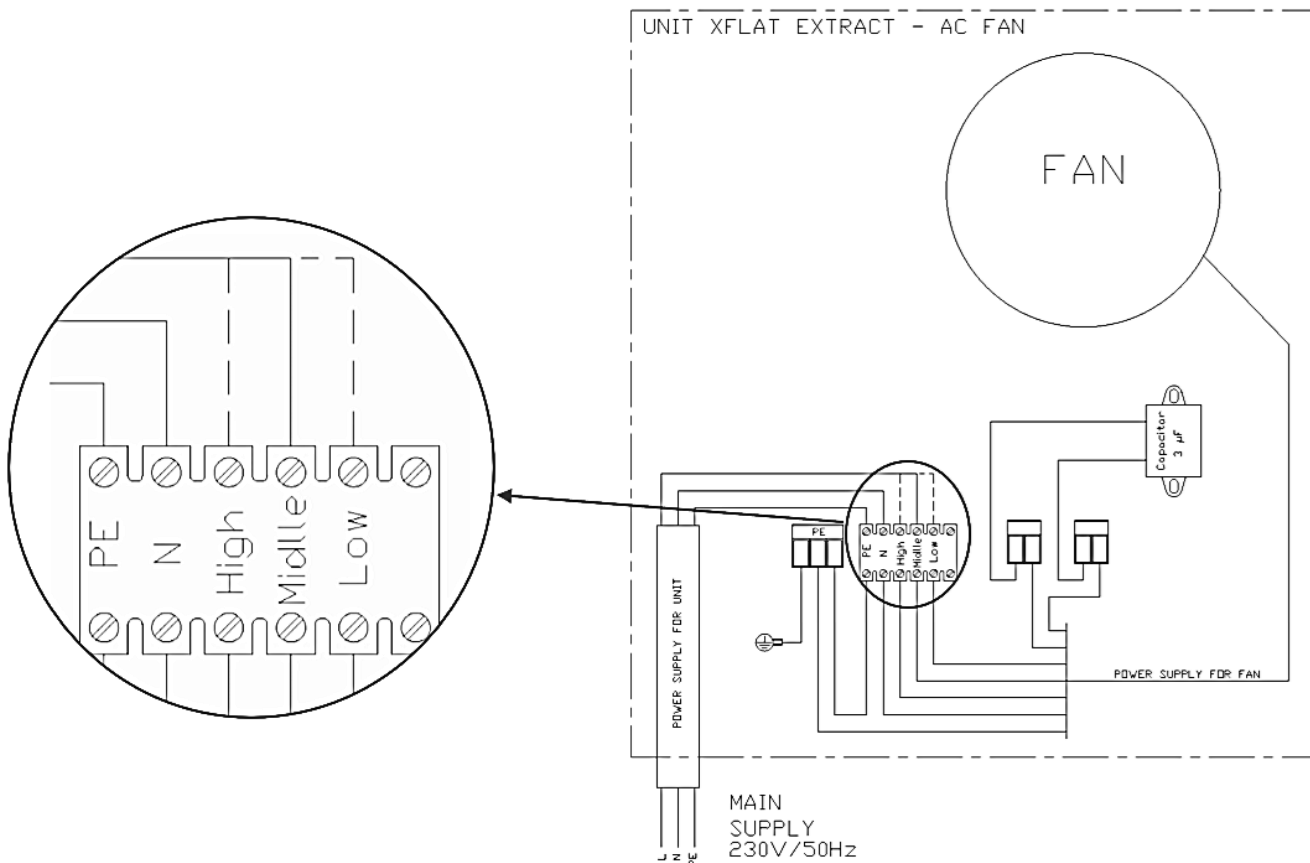

- All wires must be connected to the terminals with reasonable force to avoid damage or damage to the electrical board.

**- Control – Unit Setting – XF1-EXTRACT-EC**



- Adjust the airflow of the unit using the built-in potentiometer on the surface of the casing according to point 2) Technical parameters

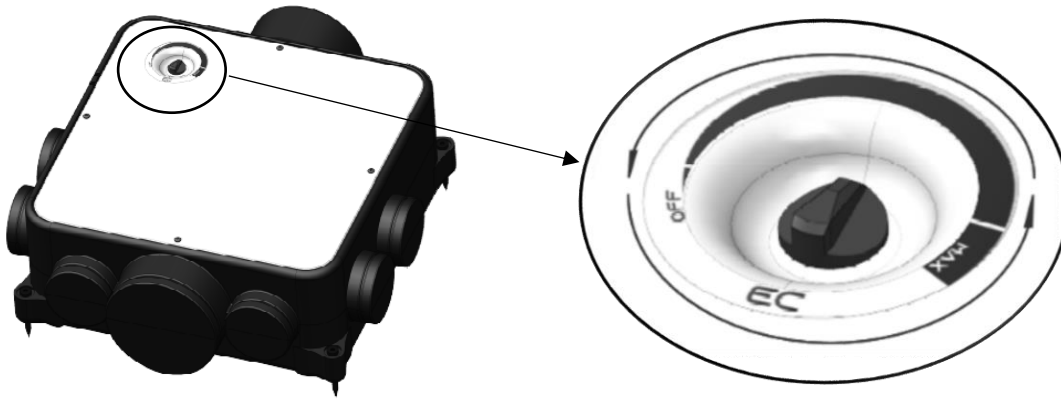

- further information about the unit and service is provided in the full manual on the company's website